

PRELIMINARY

# K3 LONG THROW LINE SOURCE



Part of the K Series, K3 is a full range line source element designed for mid-sized mobile applications. Housing the internationally recognized K2 components, K3 offers uncompromised large format system sonic performance in a compact enclosure.

K3 delivers exceptional bandwidth with reinforced LF contour for its size and high output capacity for use as a stand-alone line source. Designed as a two-way active loudspeaker, K3 requires two channels of amplification resulting in high density of loudspeaker per amplified controller.

K3 features Panflex™ to increase flexibility. A single enclosure offers four horizontal directivity patterns: 70° or 110° symmetrical or 90° asymmetrical on either side. Ultra-precise audience coverage and smooth SPL distribution is granted by the combination of Panflex and a large choice of inter-element angles.

The rugged K3 enclosure integrates an efficient, captive rigging system fitted with visual safety for secured and effortless deployment. A comprehensive set of rigging and transportation accessories facilitate storage, truck-loading and multiply deployment options.

## SPECIFICATIONS

<b>Description</b>	2-way active WST enclosure, amplified by LA4X/LA8/LA12X
<b>Usable bandwidth (-10 dB)</b>	42 Hz - 20 kHz ([K3_70])
<b>Maximum SPL<sup>1</sup></b>	143 dB ([K3_70])
<b>Nominal directivity</b>	Vertical : depending on number of elements and array curvature Horizontal : 70°/110° symmetric or 90° asymmetric
<b>Transducers</b>	LF: 2 x 12" neodymium cone driver HF: 1 x 4" diaphragm neodymium compression driver
<b>Acoustical load</b>	LF: Bass-reflex, L-Vents HF: DOSC waveguide, Panflex
<b>Nominal impedance</b>	LF/HF : 8 Ω/8 Ω
<b>Connectors</b>	2 x 4-point speakON
<b>Rigging and handling</b>	4-point captive rigging system 2 large side handles Inter-enclosure angles [deg]: 0.25, 1, 2, 3, 4, 5, 7.5, 10
<b>Weight (net)</b>	43 kg/94.7 lb
<b>Cabinet</b>	Premium grade Baltic birch plywood
<b>Side panels</b>	Die cast aluminum
<b>Front</b>	Coated steel grill Acoustically neutral 3D fabric
<b>Rigging components</b>	High grade steel with anti-corrosion coating
<b>Finish</b>	Dark grey brown Pantone 426 C
<b>IP</b>	IP55

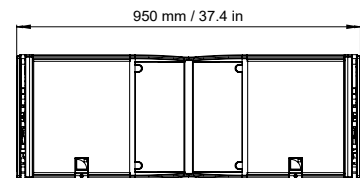

Front

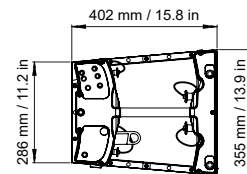

Side

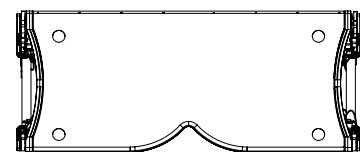

Top

<sup>1</sup> Peak level at 1 m under free field conditions using pink noise with crest factor 4 (preset specified in brackets).